

## BEDROOM PLAN

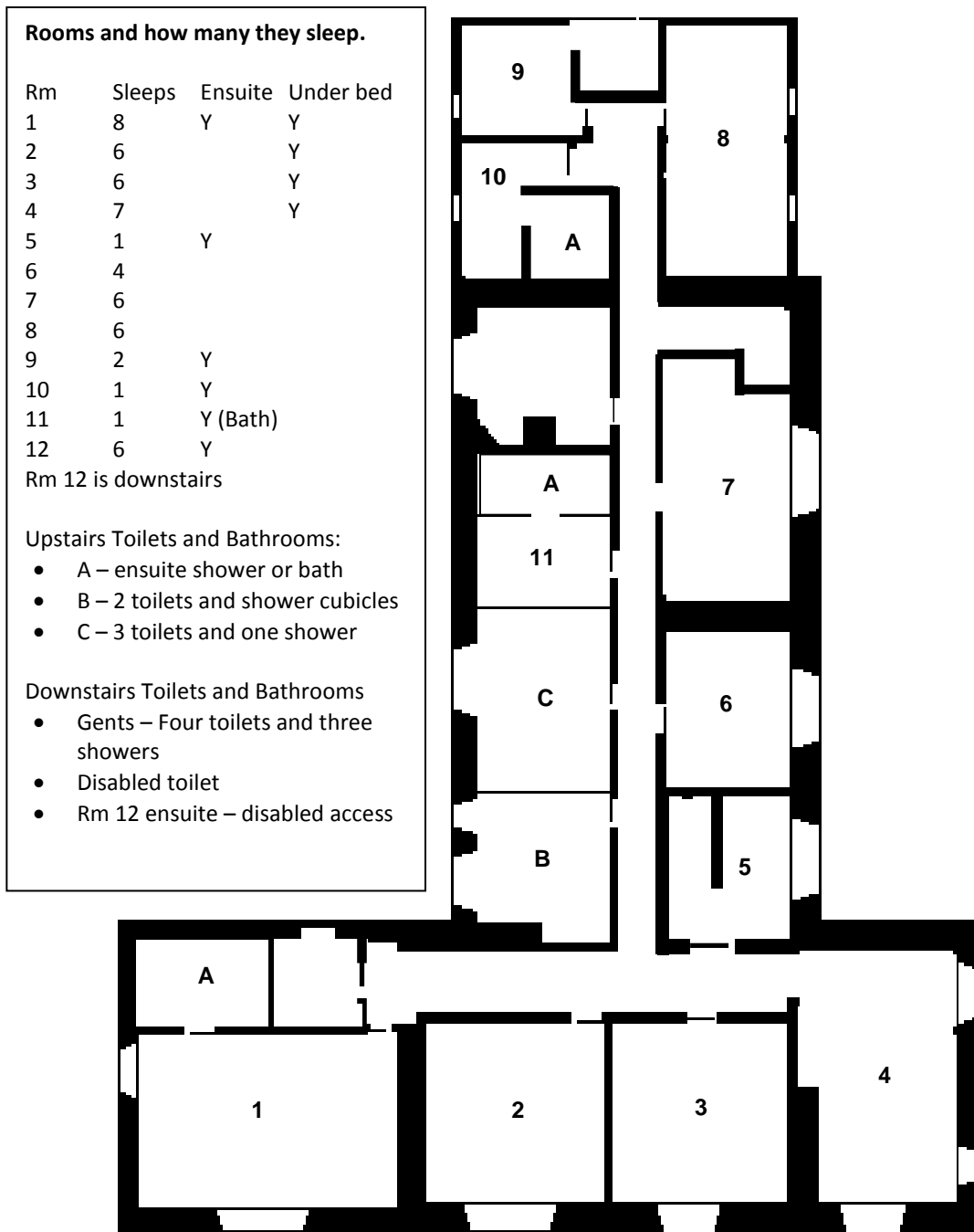

Please note

- Room 12 is downstairs
- 2 of the beds in room 7 are only suitable for people smaller than 5 foot 6 inches
- In rooms 1,2,3 and 4 there is an extra pull out bed, but we do not recommend these are used for any more than a weekend event.
- A narrow mattress is available, and if necessary can be put in Rm 9 or 11
- A travel cot and high chair is also available.